

AVAILABLE FOR SALE/LEASE

±93,280 SF INDUSTRIAL BUILDING



15220 CANARY AVENUE
LA MIRADA | CALIFORNIA

PROPERTY FEATURES:

- ±93,280 square foot industrial building
- ±4,980 square feet of office space
- ±162,479 square foot parcel
- Large fenced yard
- Shop restrooms
- Fully fire sprinklered
- Clear height:
 - 47,200 SF - 14' min. clearance
 - 46,080 SF - 21' min. clearance
- 1,200 & 400 amp electrical panels
- 7 dock high doors & 1 ground level door
- Rail spur possible

For More Information, Contact:

SCOTT SMITH

Senior Vice President

License ID# 00796049

714.478.7405

ssmith@lee-associates.com

JUSTIN SMITH

Senior Vice President

License ID# 01504494

949.790.3151

jbsmith@lee-associates.com

GRANT LABOUNTY

Associate

License ID# 02086573

949.790.3120

glabounty@leeirvine.com

AVAILABLE FOR SALE/LEASE

±93,280 SF INDUSTRIAL BUILDING

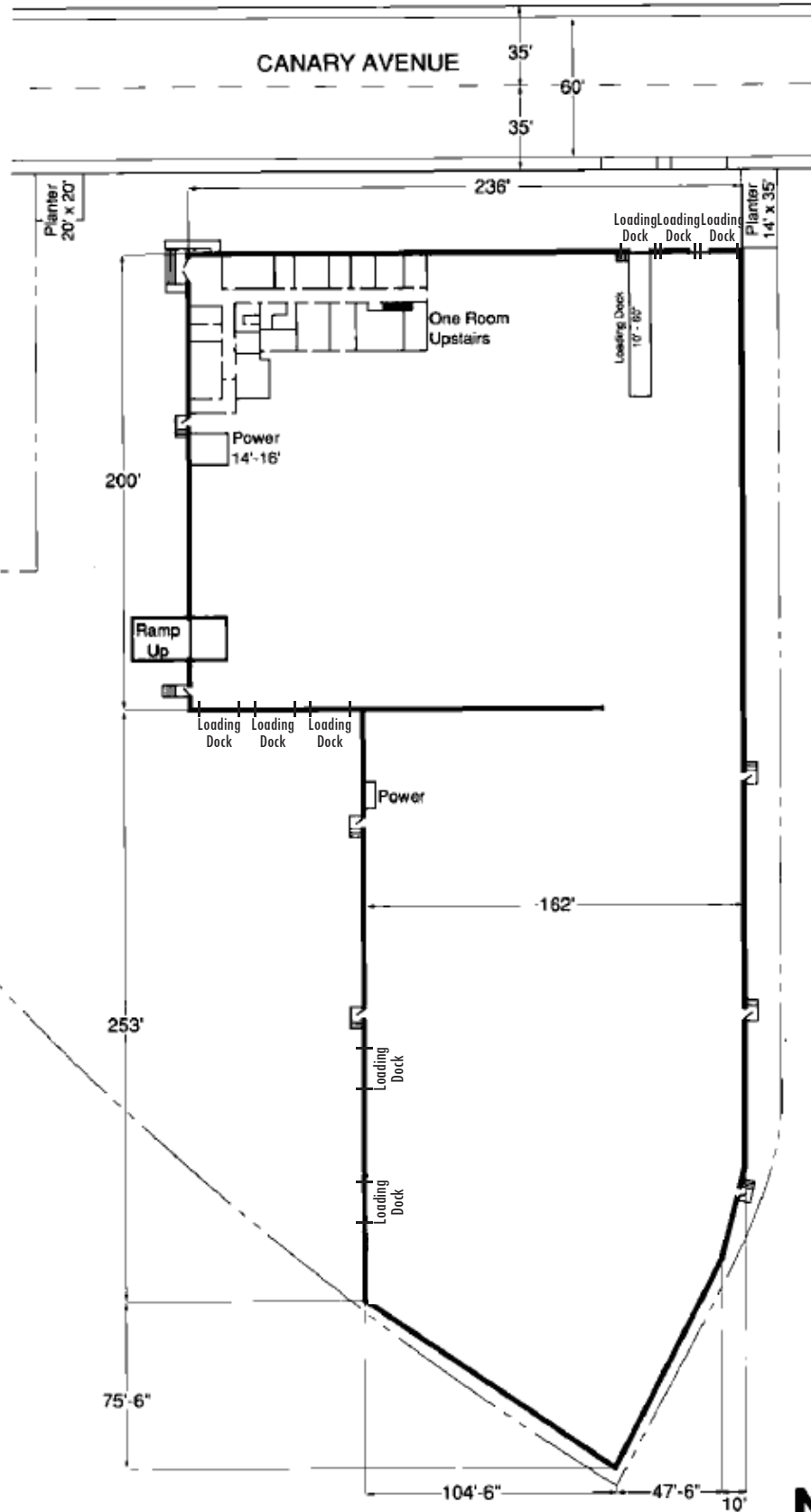

For More Information, Contact:

SCOTT SMITH
 Senior Vice President
 License ID# 00796049
 714.478.7405
 ssmith@lee-associates.com

JUSTIN SMITH
 Senior Vice President
 License ID# 01504494
 949.790.3151
 jbsmith@lee-associates.com

GRANT LABOUNTY
 Associate
 License ID# 02086573
 949.790.3120
 glabounty@leeirvine.com